

09/08/99

CONTRACT NO.: DA00380 WBS ELEMENT: 2018CPT.01.10.20271.1,ETC.

STATE OF NORTH CAROLINA  
DIVISION OF HIGHWAYS

**CURRITUCK COUNTY**

STATE	STATE PROJECT REFERENCE NO.	SHEET NO.	TOTAL NO.
N.C.	2018CPT.01.10.20271.1,ETC.		
STATE PROJ. NO.	F.A. PROJ. NO.	DESCRIPTION	
2018CPT.01.10.20271.1		MAP 1	
2018CPT.01.10.20272.1		MAP 2	
2018CPT.01.10.20272.1		MAP 3	
2018CPT.01.10.20272.1		MAP 4	
2018CPT.01.10.20272.1		MAP 5	
2018CPT.01.10.20272.1		MAP 6	
2018CPT.01.10.20272.1		MAP 7	



**LOCATION:** MAP 1 SR 1437 NORTH BEACH ACCESS FROM DEAD END TO NC 12  
 MAP 2 SR 1422 SANDHILL LANE FROM CUL-DE-SAC TO NC 12  
 MAP 3 SR 1423 SANDBUCKET ARCH RD FROM CUL-DE-SAC TO CUL-DE-SAC  
 MAP 4 SR 1424 SEA SHELL LANE FROM CUL-DE-SAC TO NC 12  
 MAP 5 SR 1425 CONCH CRESENT FROM CUL-DE-SAC TO CUL-DE-SAC  
 MAP 6 SR 1426 OCEAN WAY RD FROM CUL-DE-SAC TO NC 12  
 MAP 7 SR 1427 BREAKERS ARCH RD FROM CUL-DE-SAC TO CUL-DE-SAC

**TYPE OF WORK: RESURFACING & SHOULDER RECONSTRUCTION**

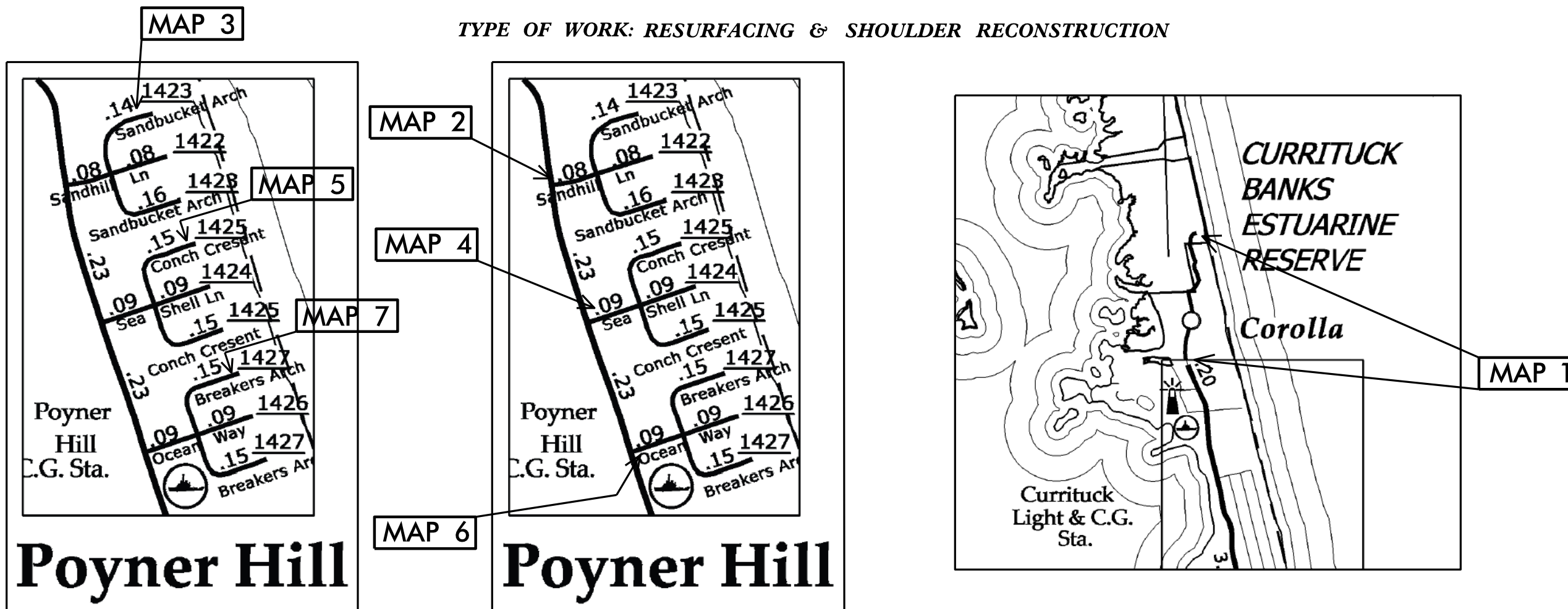

**Poyner Hill**

**Poyner Hill**

**NTS**

**PROJECT LENGTH**

LENGTH OF ROADWAY PROJECT MAP 1 = 1.07 MI  
 LENGTH OF ROADWAY PROJECT MAP 2 = 0.18 MI  
 LENGTH OF ROADWAY PROJECT MAP 3 = 0.34 MI  
 LENGTH OF ROADWAY PROJECT MAP 4 = 0.20 MI  
 LENGTH OF ROADWAY PROJECT MAP 5 = 0.36 MI  
 LENGTH OF ROADWAY PROJECT MAP 6 = 0.19 MI  
 LENGTH OF ROADWAY PROJECT MAP 7 = 0.36 MI

Prepared in the Office of:  
**DIVISION OF HIGHWAYS**

113 Airport Dr., Edenton NC, 27932

2012 STANDARD SPECIFICATIONS

LETTING DATE:

W. B. HOBBS, P.E.  
DIVISION PROJECT MANAGER

C. E. SLACHTA  
DIVISION PROPOSALS ENGINEER

**DIVISION OF HIGHWAYS  
STATE OF NORTH CAROLINA**

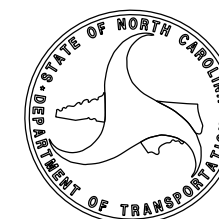

DRAWN BY: JWC

09/08/99

CONTRACT NO.: DA00380 WBS ELEMENT: 2018CPT.01.10.20271.1,ETC.

STATE OF NORTH CAROLINA  
DIVISION OF HIGHWAYS

**CURRITUCK COUNTY**



STATE	STATE PROJECT REFERENCE NO.	SHEET NO.	TOTAL NO.
N.C.	2018CPT.01.10.20271.1,ETC.		
STATE PROJ. NO.	F.A. PROJ. NO.	DESCRIPTION	
2018CPT.01.10.20272.1		MAP 8	
2018CPT.01.10.20272.1		MAP 9	
2018CPT.01.10.20272.1		MAP 10	
2018CPT.01.10.20272.1		MAP 11	
2018CPT.01.10.20272.1		MAP 12	
2018CPT.01.10.20272.1		MAP 13	
2018CPT.01.10.20272.1		MAP 14	
2018CPT.01.10.20272.1		MAP 15	

**LOCATION:** MAP 8 SR 1406 SCHOOL HOUSE LN FROM SR 1185 TO NC 12  
 MAP 9 SR 1185 COROLLA VILLAGE RD FROM CUL-DE-SAC TO NC 12  
 MAP 10 SR 1400 COROLLA DR FROM SR 1402 TO SR 1409  
 MAP 11 SR 1402 ALBACORE ST FROM SR 1403 TO NC 12  
 MAP 12 SR 1409 SHAD ST FROM SR 1403 TO NC 12  
 MAP 13 SR 1420 WHALEHEAD DR FROM SR 1409 TO SR 1402  
 MAP 14 SR 1457 BONITA ST FROM SR 1403 TO NC 12  
 MAP 15 SR 1458 DOLPHIN ST FROM SR 1403 TO NC 12

**TYPE OF WORK: RESURFACING**

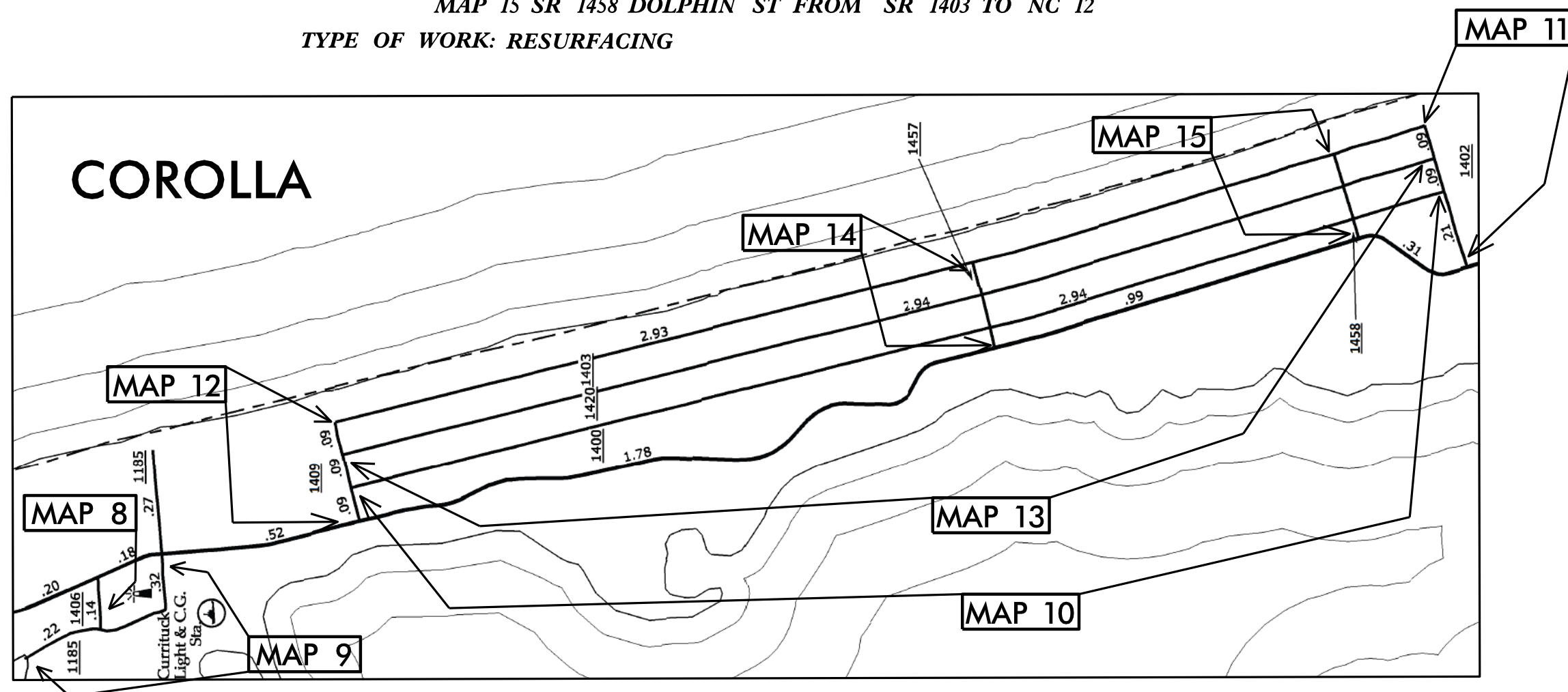

**NTS**

PROJECT LENGTH	
LENGTH OF ROADWAY PROJECT MAP 8	= 0.13 MI
LENGTH OF ROADWAY PROJECT MAP 9	= 0.52 MI
LENGTH OF ROADWAY PROJECT MAP 10	= 2.93 MI
LENGTH OF ROADWAY PROJECT MAP 11	= 0.37 MI
LENGTH OF ROADWAY PROJECT MAP 12	= 0.27 MI
LENGTH OF ROADWAY PROJECT MAP 13	= 2.93 MI
LENGTH OF ROADWAY PROJECT MAP 14	= 0.22 MI
LENGTH OF ROADWAY PROJECT MAP 15	= 0.22 MI

Prepared in the Office of:  
**DIVISION OF HIGHWAYS**  
 113 Airport Dr., Edenton NC, 27932

---

2012 STANDARD SPECIFICATIONS

LETTING DATE: \_\_\_\_\_

W. B. HOBBS, P.E.  
 DIVISION PROJECT MANAGER

C. E. SLACHTA  
 DIVISION PROPOSALS ENGINEER

**DIVISION OF HIGHWAYS**  
 STATE OF NORTH CAROLINA

DRAWN BY: JWC

09/08/99

CONTRACT NO.: DA00380 WBS ELEMENT: 2018CPT.01.10.20271.1,ETC.

STATE OF NORTH CAROLINA  
DIVISION OF HIGHWAYS

**DARE COUNTY**

LOCATION: MAP 16 SR 1113 MASHOES RD FROM STATION 52+80 TO DEAD END  
MAP 17 SR 1197 AGONA ST FROM US 64 TO NC 400

TYPE OF WORK: RESURFACING, MILLING & SHOULDER RECONSTRUCTION

STATE	STATE PROJECT REFERENCE NO.	SHEET NO.	TOTAL NO.
N.C.	2018CPT.01.10.20271.1,ETC.		
STATE PROJ.NO.	F.A. PROJ.NO.	DESCRIPTION	
2018CPT.01.10.20281.1		MAP 16	
2018CPT.01.10.20281.1		MAP 17	

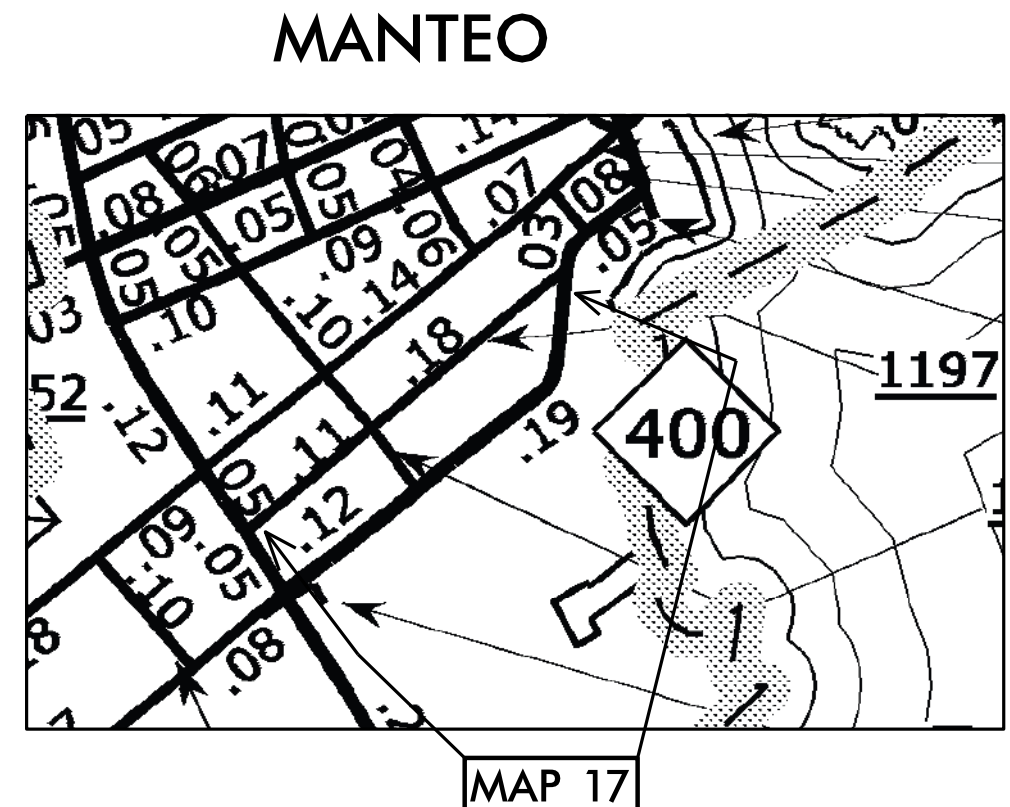
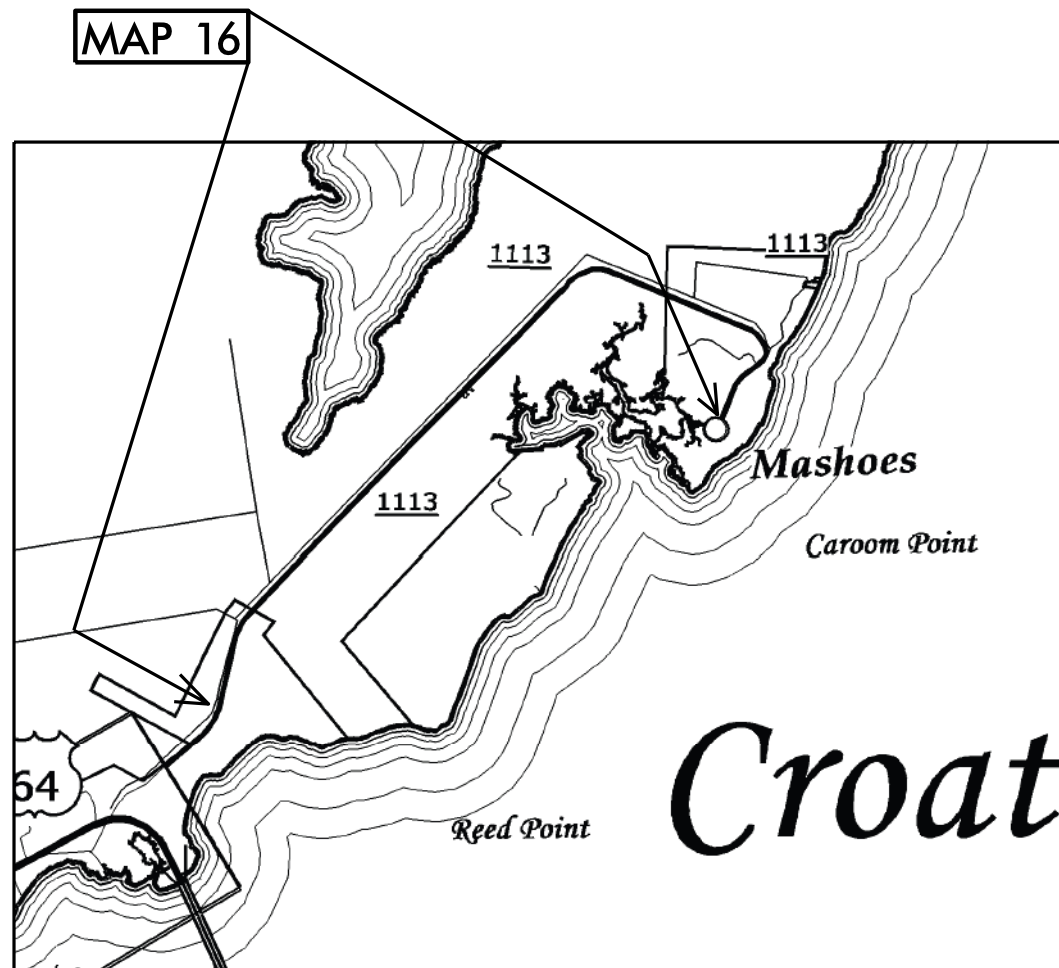
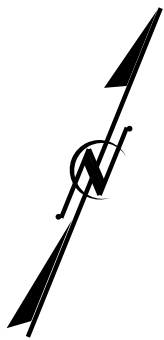

**NTS**

PROJECT LENGTH  
LENGTH OF ROADWAY PROJECTMAP 16 = 4.73 MI  
LENGTH OF ROADWAY PROJECTMAP 17 = 0.28 MI

Prepared in the Office of:  
**DIVISION OF HIGHWAYS**  
113 Airport Dr., Edenton NC, 27932

2012 STANDARD SPECIFICATIONS

LETTING DATE:

W. B. HOBBS, P.E.  
DIVISION PROJECT MANAGER

C. E. SLACHTA  
DIVISION PROPOSALS ENGINEER

DIVISION OF HIGHWAYS  
STATE OF NORTH CAROLINA

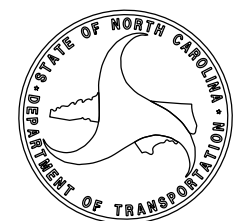

DRAWN BY: JWC



09/08/99

CONTRACT NO.: DA00380 WBS ELEMENT: 2018CPT.01.10.20271.1,ETC.

DRAWN BY: JWC

STATE OF NORTH CAROLINA  
DIVISION OF HIGHWAYS

**DARE COUNTY**

STATE	STATE PROJECT REFERENCE NO.	SHEET NO.	TOTAL NO.
N.C.	2018CPT.01.10.20271.1,ETC.		
STATE PROJ.NO.	F.A. PROJ.NO.	DESCRIPTION	
2018CPT.01.10.20281.1		MAP 27	
2018CPT.01.10.20281.1		MAP 28	
2018CPT.01.10.20281.1		MAP 29	
2018CPT.01.10.20281.1		MAP 30	
2018CPT.01.10.20281.1		MAP 31	
2018CPT.01.10.20281.1		MAP 53	



**LOCATION:** MAP 27 SR 1119 GEORGE DANIELS RD FROM SR 1118 TO SR 1354  
 MAP 28 SR 1354 OLD CEMETARY RD FROM SR 1119 TO SR 1337  
 MAP 29 SR 1337 WESCOTT PARK FROM SR 1119 TO SR 1354  
 MAP 30 SR 1121 WINGINA AVE FROM SR 1995 TO SR 1150  
 MAP 31 SR 1150 BUDLEIGH ST FROM US 64 TO NC 400  
 MAP 53 SR 1297 POTESKEET DR FROM NC 12 TO DEAD END

**TYPE OF WORK:** RESURFACING, MILLING & SHOULDER RECONSTRUCTION

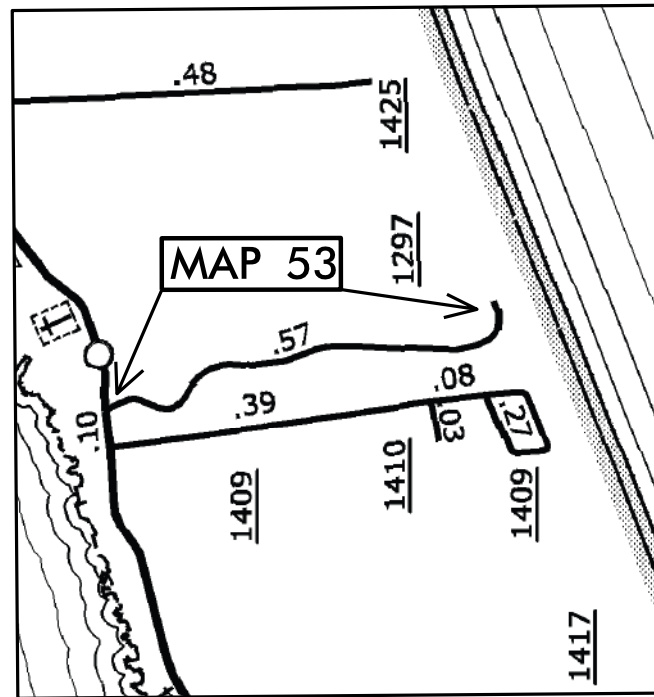
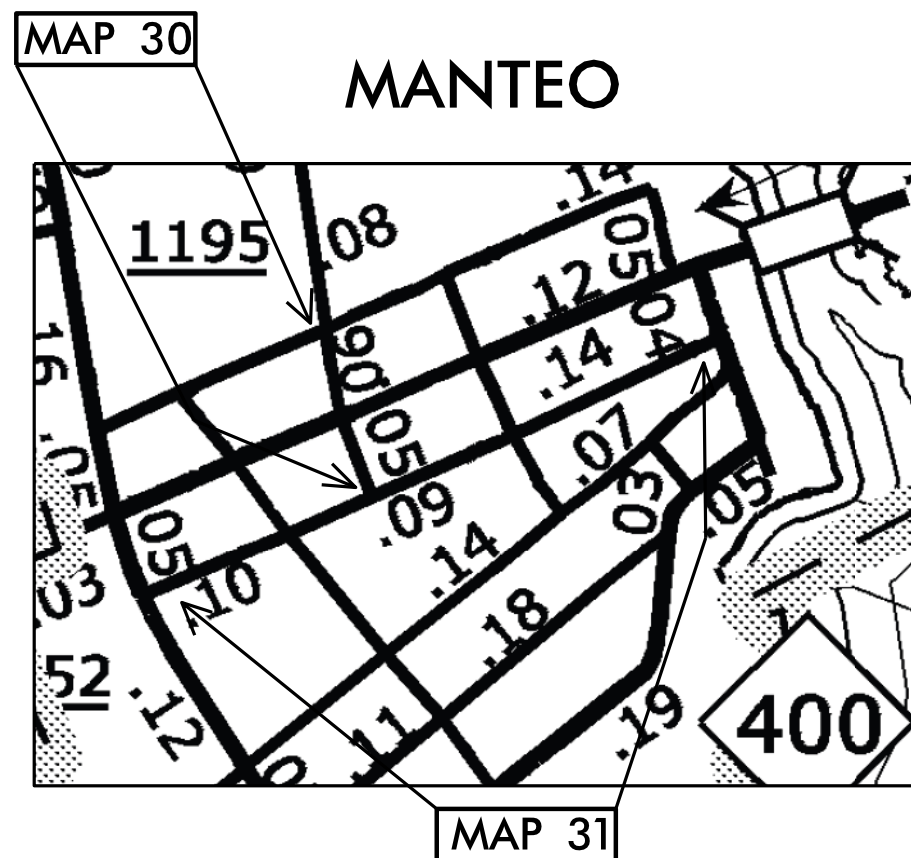

09/08/99

CONTRACT NO.: DA00380 WBS ELEMENT: 2018CPT.01.10.20271.1,ETC.

DRAWN BY: JWC

STATE OF NORTH CAROLINA  
DIVISION OF HIGHWAYS

**DARE COUNTY**

STATE	STATE PROJECT REFERENCE NO.	SHEET NO.	TOTAL NO.
N.C.	2018CPT.01.10.20271.1,ETC.		
STATE PROJ.NO.	F.A. PROJ.NO.	DESCRIPTION	
2018CPT.01.10.20282.1		MAP 32	
2018CPT.01.10.20282.1		MAP 33	
2018CPT.01.10.20282.1		MAP 34	
2018CPT.01.10.20282.1		MAP 35	
2018CPT.01.10.20282.1		MAP 38	
2018CPT.01.10.20282.1		MAP 41	



**LOCATION:** MAP 32 SR 1113 MASHOES RD FROM US 64 TO STATION 52+80  
 MAP 33 SR 1524 TERN ST FROM NC 12 TO SR 1421  
 MAP 34 SR 1525 YUCCA ST FROM NC 12 TO SR 1421  
 MAP 35 SR 1422 PAMPAS ST FROM NC 12 TO SR 1421  
 MAP 38 SR 1421 OCEAN VIEW DR FROM NC 12 TO CUL-DE-SAC  
 MAP 41 SR 1494 MOORE WAY FROM NC 12 TO CUL-DE-SAC

**TYPE OF WORK:** RESURFACING & SHOULDER RECONSTRUCTION

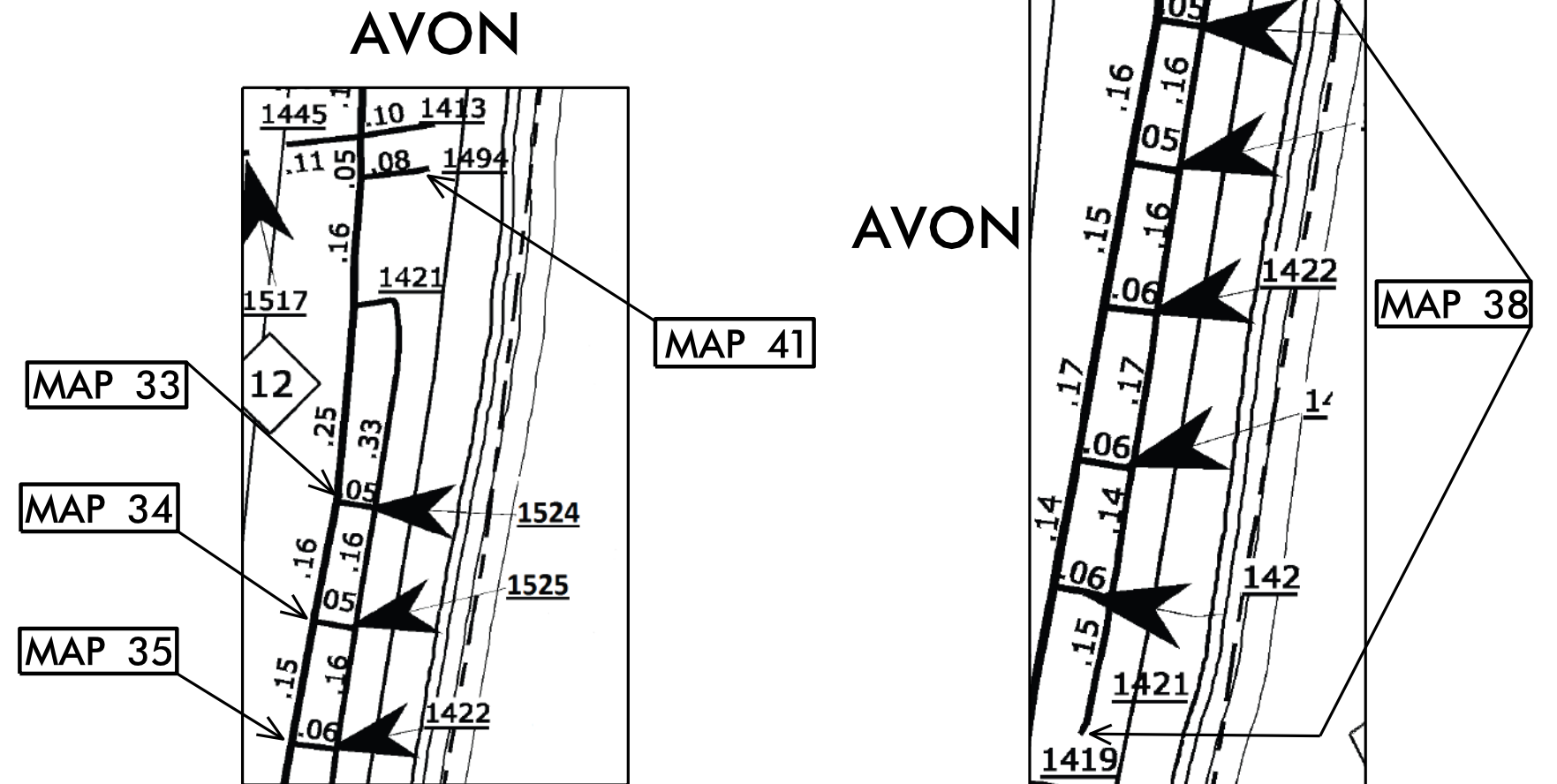
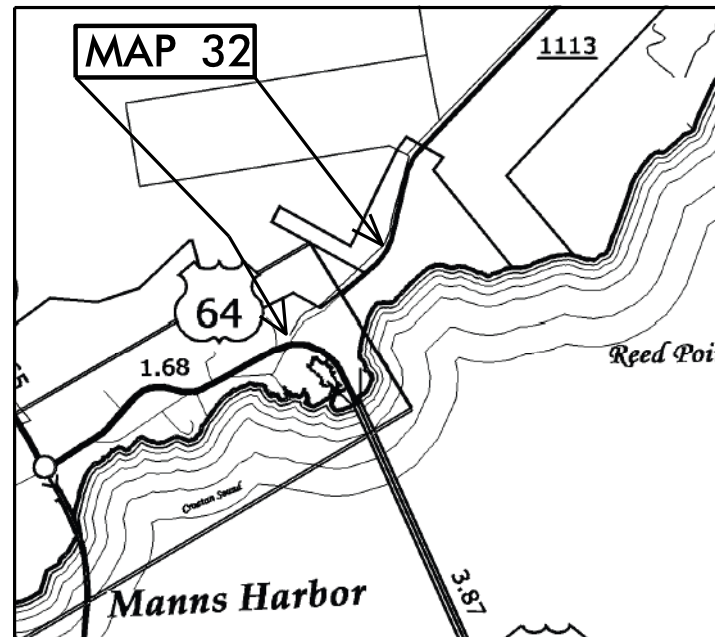

**NTS**

**PROJECT LENGTH**

LENGTH OF ROADWAY PROJECT MAP 32	= 1.00 MI
LENGTH OF ROADWAY PROJECT MAP 33	= 0.05 MI
LENGTH OF ROADWAY PROJECT MAP 34	= 0.05 MI
LENGTH OF ROADWAY PROJECT MAP 35	= 0.06 MI
LENGTH OF ROADWAY PROJECT MAP 38	= 1.09 MI
LENGTH OF ROADWAY PROJECT MAP 41	= 0.09 MI

Prepared in the Office of:  
**DIVISION OF HIGHWAYS**

113 Airport Dr., Edenton NC, 27932

2012 STANDARD SPECIFICATIONS

LETTING DATE:

W. B. HOBBS, P.E.  
 DIVISION PROJECT MANAGER

C. E. SLACHTA  
 DIVISION PROPOSALS ENGINEER

**DIVISION OF HIGHWAYS**  
 STATE OF NORTH CAROLINA

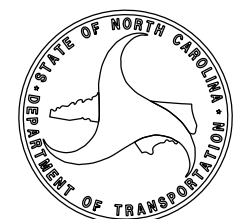

09/08/99

CONTRACT NO.: DA00380 WBS ELEMENT: 2018CPT.01.10.20271.1,ETC.



STATE OF NORTH CAROLINA  
DIVISION OF HIGHWAYS

**DARE COUNTY**

STATE	STATE PROJECT REFERENCE NO.	SHEET NO.	TOTAL NO.
N.C.	2018CPT.01.10.20271.1,ETC.		
STATE PROJ.NO.	F.A. PROJ.NO.	DESCRIPTION	
2018CPT.01.10.20282.1		MAP 36	
2018CPT.01.10.20282.1		MAP 37	
2018CPT.01.10.20282.1		MAP 39	
2018CPT.01.10.20282.1		MAP 40	
2018CPT.01.10.20282.1		MAP 42	
2018CPT.01.10.20282.1		MAP 43	
2018CPT.01.10.20282.1		MAP 44	

LOCATION: MAP 36 SR 1423 MYRTLE ST FROM NC 12 TO SR 1421  
 MAP 37 SR 1424 SEASIDE ST FROM NC 12 TO SR 1421  
 MAP 39 SR 1419 GREENWOOD PL FROM NC 12 TO CUL-DE-SAC  
 MAP 40 SR 1420 KINNAKEET DR FROM NC 12 TO SR 1419  
 MAP 42 SR 1485 KINNAKEET DR FROM NC 12 TO SR 1486  
 MAP 43 SR 1486 PHEASANT CIRCLE FROM SR 1485 TO CUL-DE-SAC  
 MAP 44 SR 1488 CEDAR CIRCLE FROM SR 1485 TO CUL-DE-SAC

TYPE OF WORK: RESURFACING

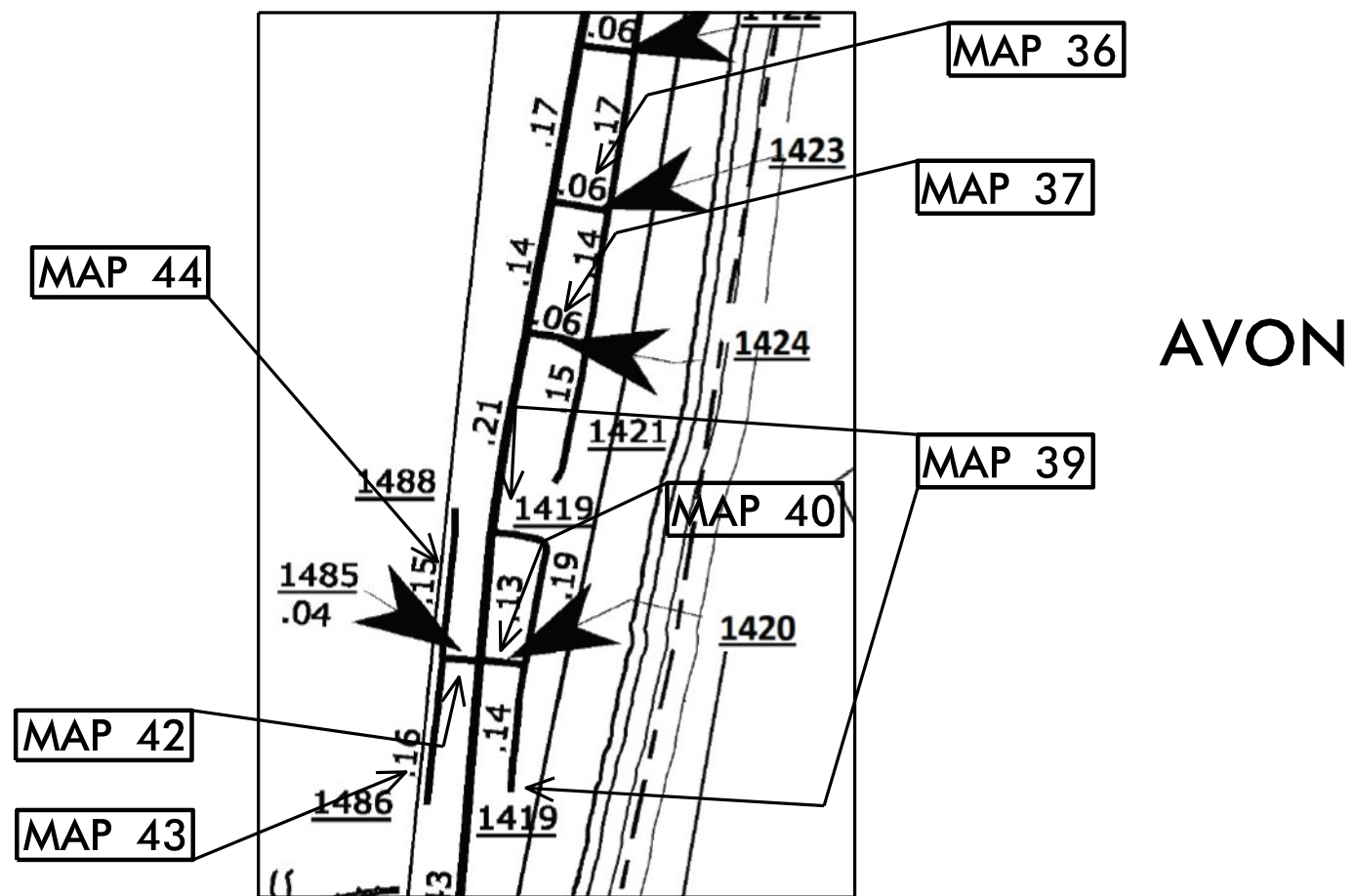

**NTS**

PROJECT LENGTH

LENGTH OF ROADWAY PROJECT MAP 36	= 0.06 MI
LENGTH OF ROADWAY PROJECT MAP 37	= 0.06 MI
LENGTH OF ROADWAY PROJECT MAP 39	= 0.32 MI
LENGTH OF ROADWAY PROJECT MAP 40	= 0.05 MI
LENGTH OF ROADWAY PROJECT MAP 42	= 0.04 MI
LENGTH OF ROADWAY PROJECT MAP 43	= 0.16 MI
LENGTH OF ROADWAY PROJECT MAP 44	= 0.16 MI

Prepared in the Office of:  
**DIVISION OF HIGHWAYS**  
 113 Airport Dr., Edenton NC, 27932

2012 STANDARD SPECIFICATIONS

LETTING DATE:

W. B. HOBBS, P.E.  
 DIVISION PROJECT MANAGER

C. E. SLACHTA  
 DIVISION PROPOSALS ENGINEER

DIVISION OF HIGHWAYS  
 STATE OF NORTH CAROLINA

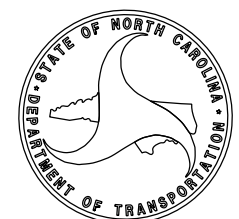

DRAWN BY: JWC

09/08/99

CONTRACT NO.: DA00380 WBS ELEMENT: 2018CPT.01.10.20271.1,ETC.

DRAWN BY: JWC

STATE OF NORTH CAROLINA  
DIVISION OF HIGHWAYS

**DARE COUNTY**

STATE	STATE PROJECT REFERENCE NO.	SHEET NO.	TOTAL NO.
N.C.	2018CPT.01.10.20271.1,ETC.		
STATE PROJ. NO.	F.A. PROJ. NO.	DESCRIPTION	
2018CPT.01.10.20282.1		MAP 45	
2018CPT.01.10.20282.1		MAP 46	
2018CPT.01.10.20282.1		MAP 47	
2018CPT.01.10.20282.1		MAP 48	
2018CPT.01.10.20282.1		MAP 49	
2018CPT.01.10.20282.1		MAP 50	
2018CPT.01.10.20282.1		MAP 51	
2018CPT.01.10.20282.1		MAP 52	



AVON

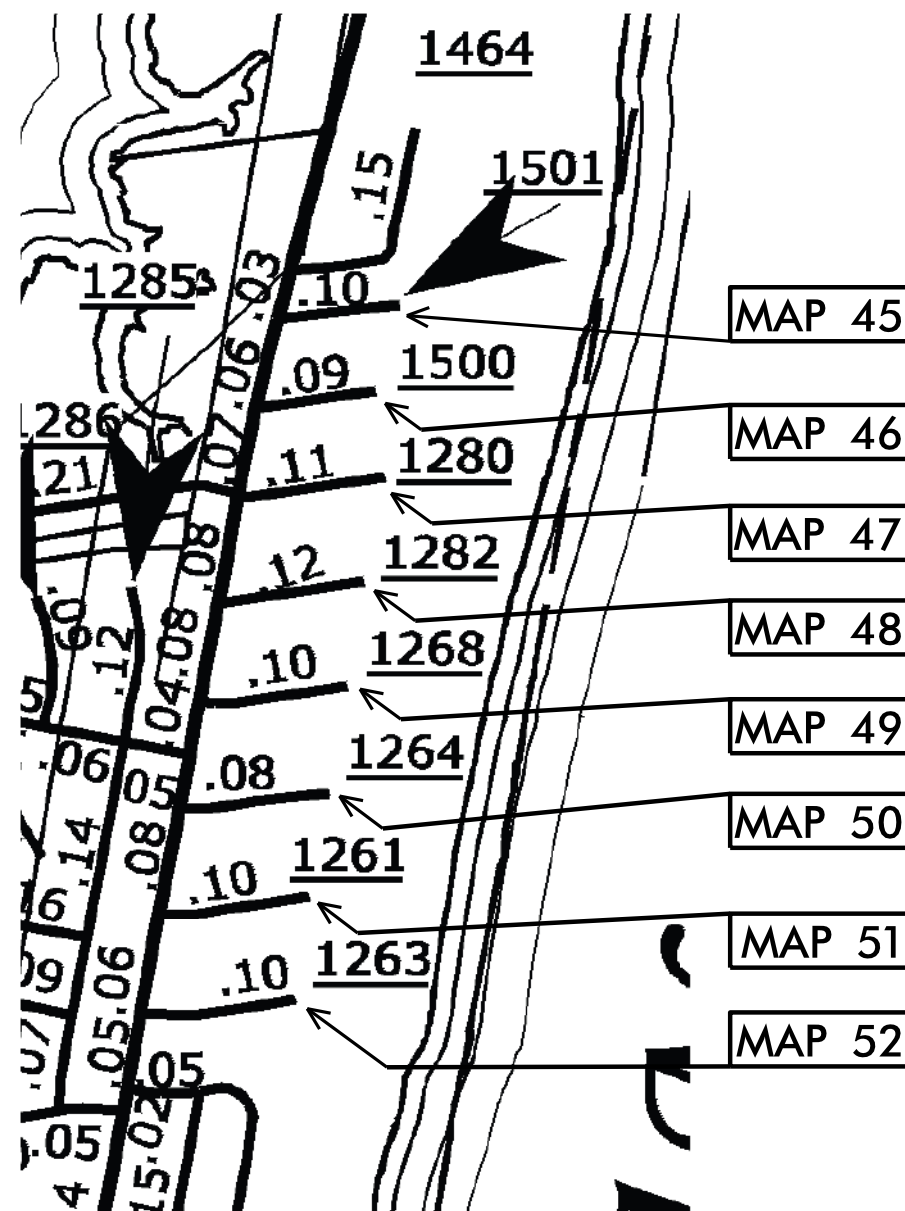

**LOCATION:** MAP 45 SR 1501 KINNAKEET DR NORTH FROM NC 12 TO CUL-DE-SAC  
 MAP 46 SR 1500 NOVA DR FROM NC 12 TO DEAD END  
 MAP 47 SR 1280 COLONY LANE FROM NC 12 TO JOLLIE RD  
 MAP 48 SR 1282 HATTERAS LANE FROM NC 12 TO JOLLIE LANE  
 MAP 49 SR 1268 WAHOO CIRCLE FROM NC 12 TO DEAD END  
 MAP 50 SR 1264 SANDFIDDLER LANE FROM NC 12 TO CUL-DE-SAC  
 MAP 51 SR 1261 ANGELFISH RD FROM NC 12 TO DEAD END  
 MAP 52 SR 1263 SAILFISH LANE FROM NC 12 TO CUL-DE-SAC

**TYPE OF WORK:** RESURFACING

**NTS**

**PROJECT LENGTH**

LENGTH OF ROADWAY PROJECT MAP 45	= 0.09 MI
LENGTH OF ROADWAY PROJECT MAP 46	= 0.09 MI
LENGTH OF ROADWAY PROJECT MAP 47	= 0.11 MI
LENGTH OF ROADWAY PROJECT MAP 48	= 0.10 MI
LENGTH OF ROADWAY PROJECT MAP 49	= 0.09 MI
LENGTH OF ROADWAY PROJECT MAP 50	= 0.08 MI
LENGTH OF ROADWAY PROJECT MAP 51	= 0.10 MI
LENGTH OF ROADWAY PROJECT MAP 52	= 0.10 MI

Prepared in the Office of:  
**DIVISION OF HIGHWAYS**

113 Airport Dr., Edenton NC, 27932

2012 STANDARD SPECIFICATIONS

LETTING DATE:

W. B. HOBBS, P.E.  
DIVISION PROJECT MANAGER

C. E. SLACHTA  
DIVISION PROPOSALS ENGINEER

**DIVISION OF HIGHWAYS  
STATE OF NORTH CAROLINA**

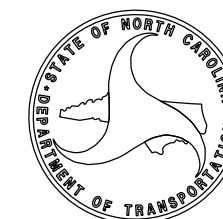



# C O N T R A C T P A V E M E N T S C H E D U L E

C1	PROP. APPROX. 1½" ASPHALT CONCRETE SURFACE COURSE, TYPE SF9.5A, AT AN AVERAGE RATE OF 165 LBS. PER SQ. YD.
C2	PROP. APPROX. ¾" ASPHALT SURFACE COURSE, TYPE S4.75A, AT AN AVERAGE RATE OF 75
T	EARTH MATERIAL
U	EXISTING PAVEMENT
V1	MILLING BITUMINOUS PAVEMENT. 1½" DEPTH.

P A V E M E N T S C H E D U L E

C2	PROP. APPROX. 3/4" ASPHALT CONCRETE SURFACE COURSE, TYPE SF4.75A, AT AN AVERAGE RATE OF 75 LBS. PER SQ. YD.
U	EXISTING PAVEMENT.

PROJECT REFERENCE NO.	SHEET NO.
2018CPT.01.10.20271.1, ETC.	

NOTES:

\*ALL PAVED ROADS TO BE RESURFACED TO THE ENDS OF THE RADII, OR AS DIRECTED BY THE ENGINEER

\*EDGES, PAVEMENT WIDENING, INTERSECTIONS, AND BRIDGE FLARES ARE INCLUDED IN THE TABLE OF QUANTITIES

\*SHOULDERS TO BE RECONSTRUCTED BY OTHERS

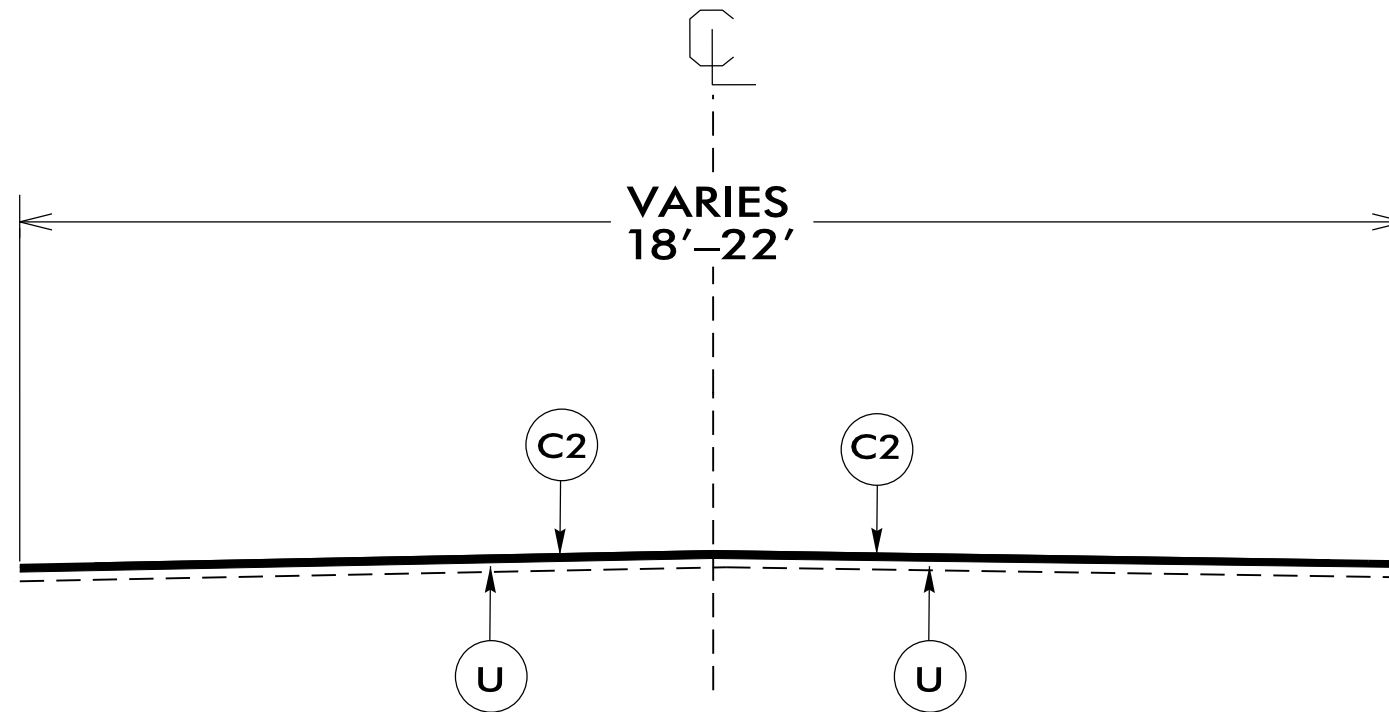

# TYPICAL SECTION NO. 1

USE WITH MAPS 2-15, 32-52

P A V E M E N T   S C H E D U L E

PROJECT REFERENCE NO.	SHEET NO.
2018CPT.01.10.20281.1	

C1	PROP. APPROX. 1½" ASPHALT CONCRETE SURFACE COURSE, TYPE SF9.5A, AT AN AVERAGE RATE OF 165 LBS. PER SQ. YD.
T	EARTH MATERIAL
U	EXISTING PAVEMENT.

NOTES:

\*ALL PAVED ROADS TO BE RESURFACED TO THE ENDS OF THE RADII, OR AS DIRECTED BY THE ENGINEER

\*EDGES, PAVEMENT WIDENING, INTERSECTIONS, AND BRIDGE FLARES ARE INCLUDED IN THE TABLE OF QUANTITIES

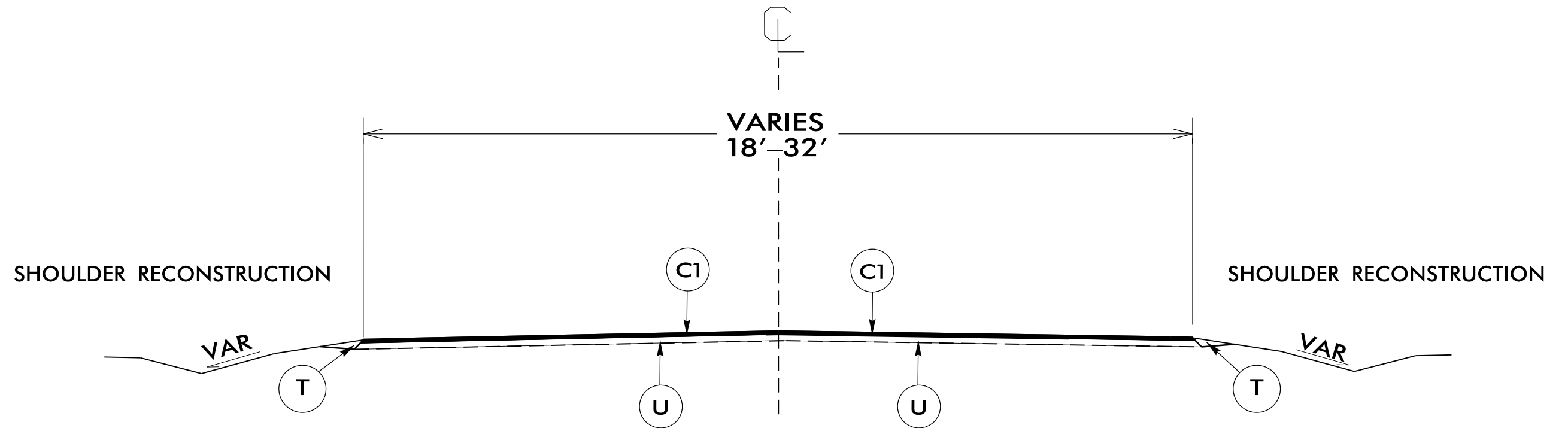

**TYPICAL SECTION NO. 2**  
 USE WITH MAPS 1, 16, 18-29 & 53

NTS

P A V E M E N T S C H E D U L E

C1	PROP. APPROX. 1½" ASPHALT CONCRETE SURFACE COURSE, TYPE SF9.5A, AT AN AVERAGE RATE OF 165 LBS. PER SQ. YD.
U	EXISTING PAVEMENT.
V1	MILLING BITUMINOUS PAVEMENT. 1½" DEPTH.

PROJECT REFERENCE NO.	SHEET NO.
2018CPT.01.10.20271.1, ETC.	

NOTES:

\*ALL PAVED ROADS TO BE RESURFACED TO THE ENDS OF THE RADII, OR AS DIRECTED BY THE ENGINEER

\*EDGES, PAVEMENT WIDENING, INTERSECTIONS, AND BRIDGE FLARES ARE INCLUDED IN THE TABLE OF QUANTITIES

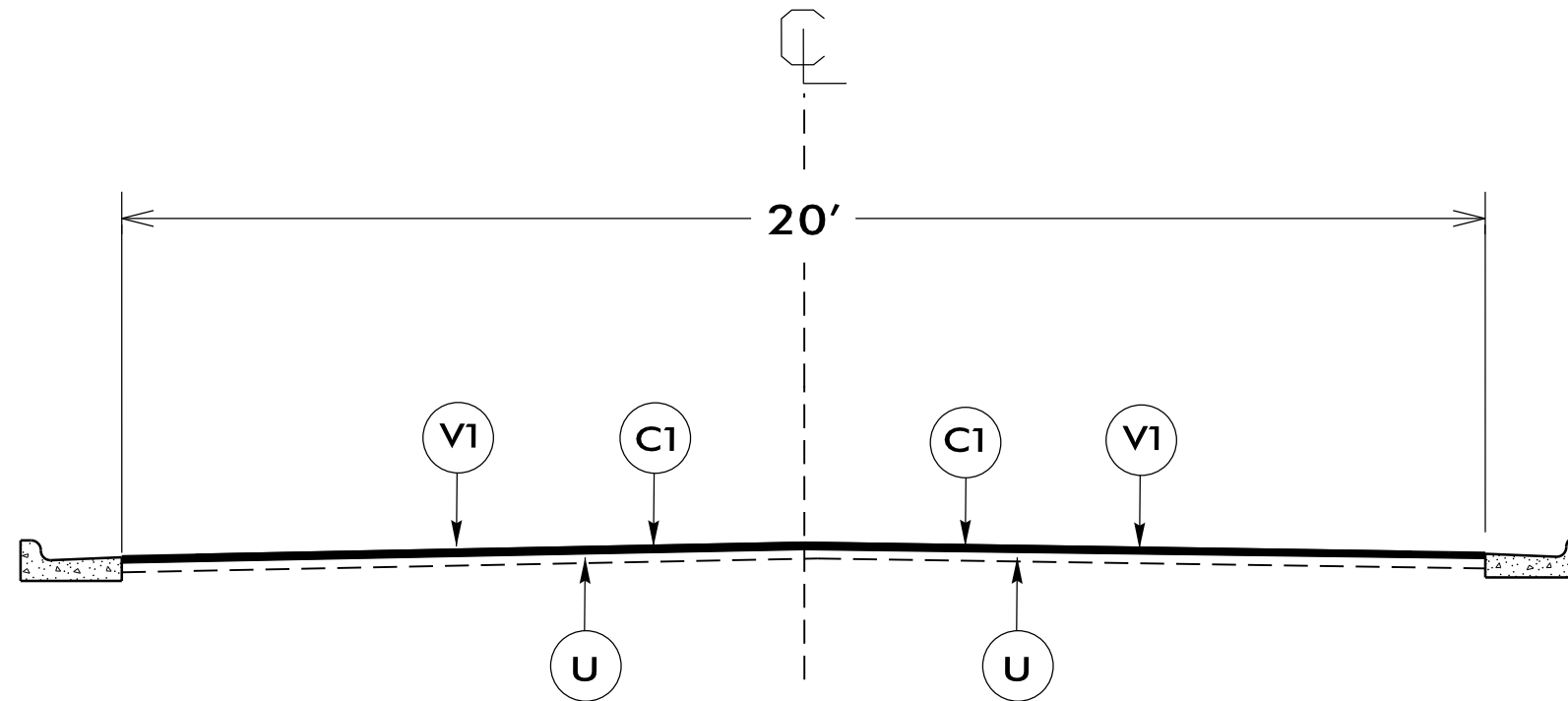

# TYPICAL SECTION NO. 3

USE WITH MAPS 17, 30 & 31

- NOTES:  
 1) DETAIL DOES NOT APPLY TO OGAFc AND ULTRA-THIN BONDED WEARING COURSE.  
 2) BACKFILL SHOULDER WITH APPROVED MATERIAL.  
 3) THE SHOULDER WEDGE DEVICE MAY BE DISENGAGED AT PAVED DRIVEWAYS AND SIDE STREETS.

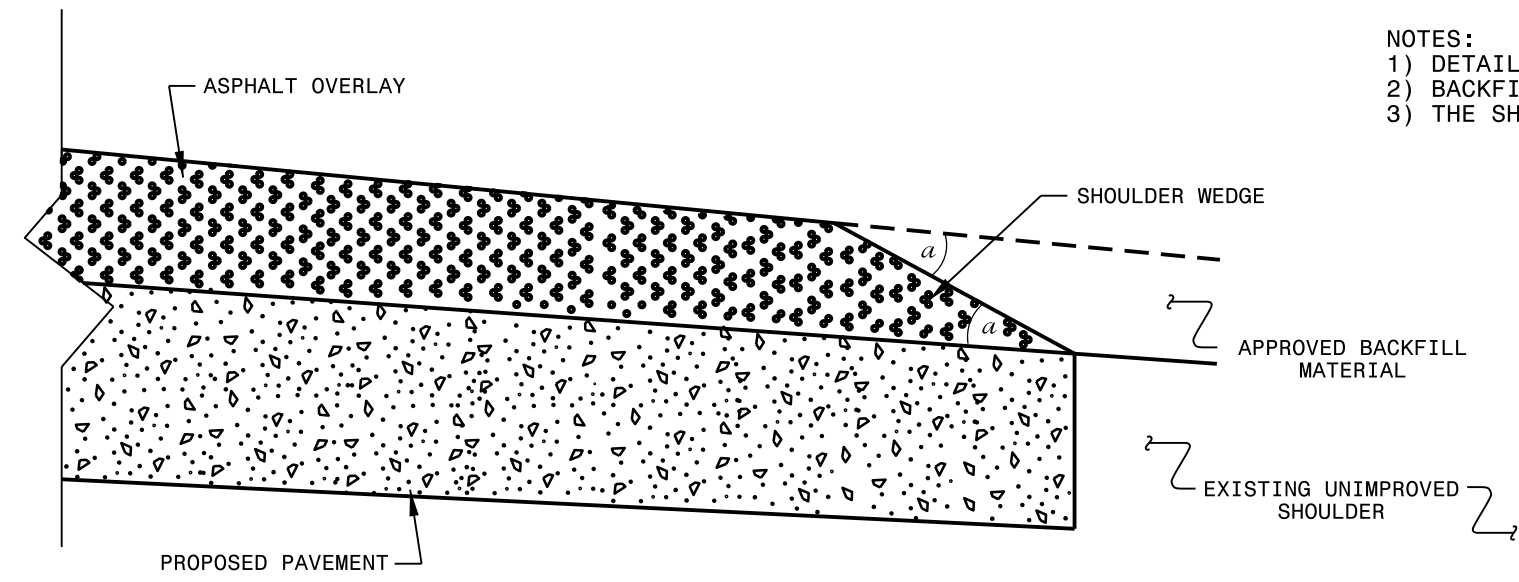

**SHOULDER WEDGE DETAIL**  
 (Resurfacing Projects w/ Widening or  
 with Existing Paved Shoulder having no dropoffs)

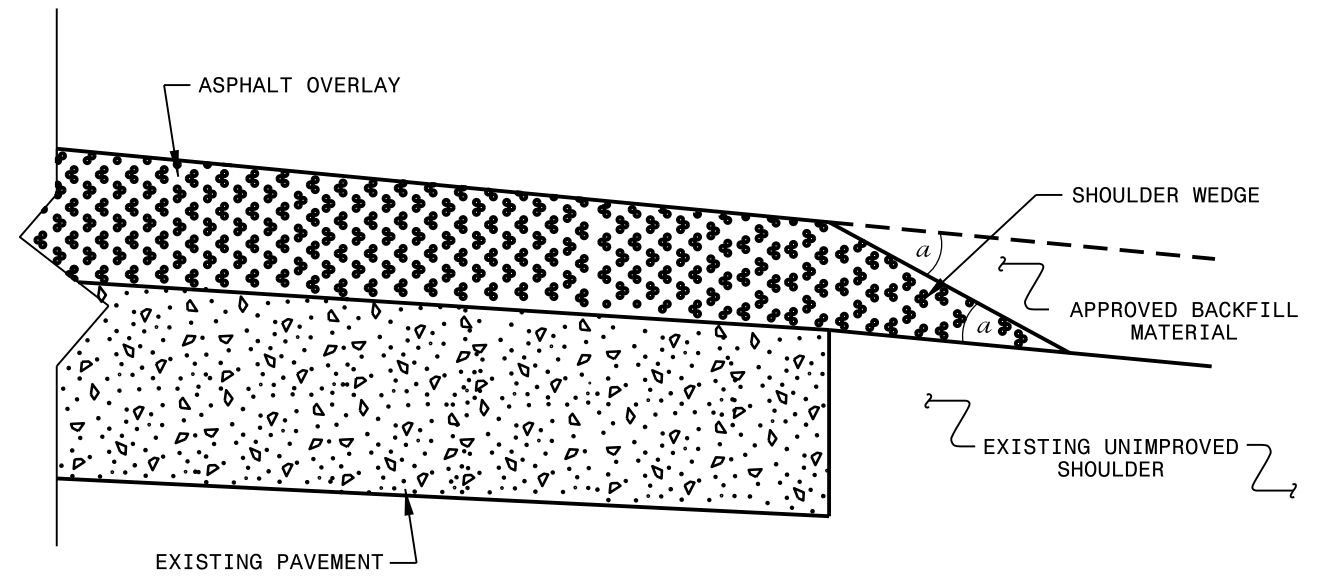

**SHOULDER WEDGE DETAIL**  
 (Resurfacing Projects w/ NO Widening)

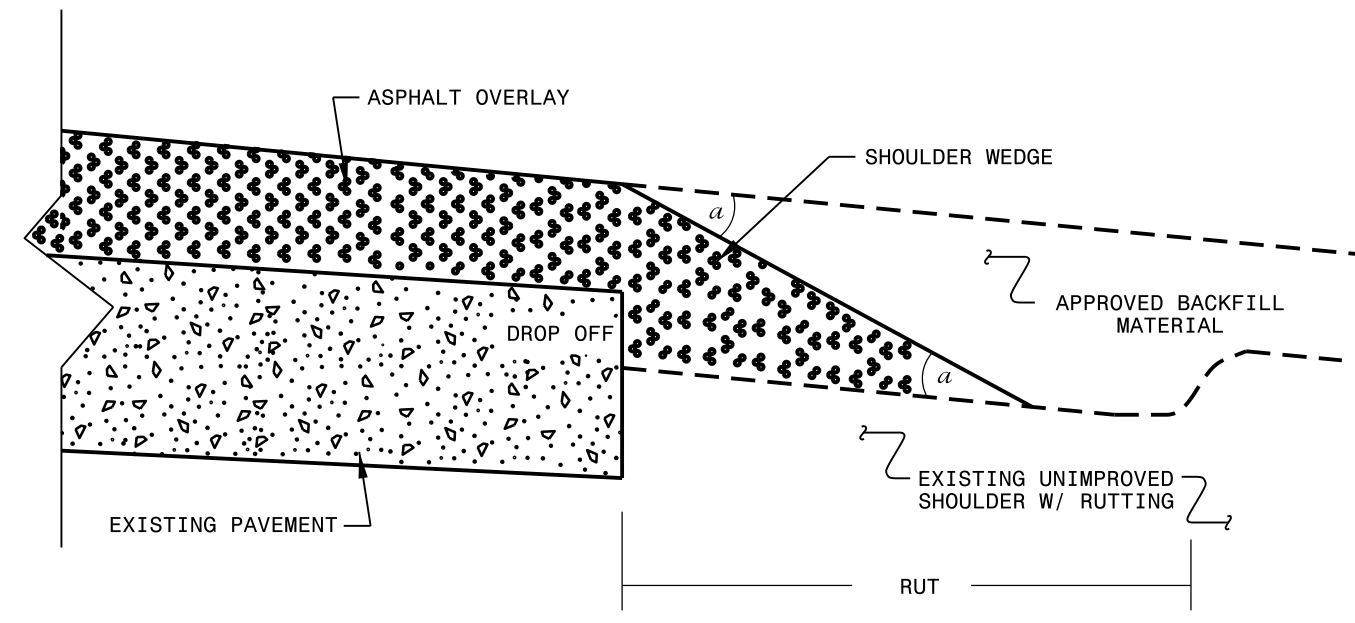

**SHOULDER WEDGE DETAIL**  
 (Resurfacing Adjacent to  
 Rutted Shoulder)

- SHOULDER WEDGE ANGLE = 30°

<b>CONTRACT STANDARDS AND DEVELOPMENT UNIT</b>			
Office 919-707-6950		FAX 919-250-4119	
<b>SHOULDER WEDGE DETAILS</b>			
ORIGINAL BY: T.SPELL	DATE: 7-19-11		
MODIFIED BY:	DATE: 10/16/12		
CHECKED BY:	DATE:		
FILE SPEC.: s:\usr\details\stand\shoulderwedgedetail.dgn			

21-SEP-2017 09:17  
 S:\usr\details\stand\shoulderwedgedetail.dgn  
 .Jeaddy At DICAD293538

## SIGNING FOR RESURFACING PROJECTS

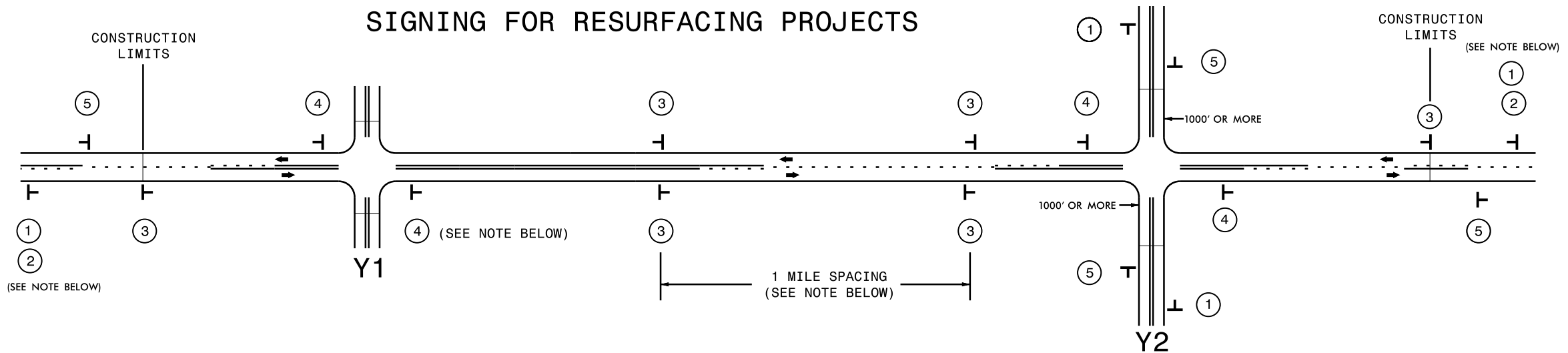

LEGEND	
T	STATIONARY SIGN
←	DIRECTION OF TRAFFIC FLOW

### MAINLINE (-L-) SIGNING

### -Y- LINE SIGNING

SIGNING NOTES AND PLACEMENT PER DIRECTION	① ②	 	<p>PLACE 1000' PRIOR TO BEGINNING OF CONSTRUCTION LIMITS. ONLY USED ON -Y- LINES IF RESURFACING LIMITS EXTEND 1000' ALONG -Y- LINE.</p> <p>#2 SIGN ONLY USED WHEN RESURFACING LIMITS ARE 2 OR MORE MILES IN LENGTH. ROUND UP TO NEXT WHOLE NUMBER. (NO FRACTIONAL OR DECIMAL NUMBERS)</p>	<p style="text-align: center;">NO REQUIRED STATIONARY SIGNING FOR THE FOLLOWING -Y- LINE CONDITIONS:</p> <ol style="list-style-type: none"> <li>1) LESS THAN 1000' OF RESURFACING ALONG -Y- LINE</li> <li>2) SUBDIVISION ROADS</li> <li>3) DEAD END ROADS</li> </ol> <p style="text-align: center;">WHEN PAVING/CONSTRUCTION ACTIVITIES PROCEED ACROSS AN UNSIGNED -Y- LINE, ADVANCE WARNING PORTABLE SIGNS SHALL BE USED ALONG THE -Y- LINE AS SHOWN BELOW. REMOVE UPON COMPLETION OF WORK.</p> <div style="display: flex; justify-content: space-around; align-items: center;"> <div style="text-align: center;">   <small>W20-1 48" X 48"</small> </div> <div style="text-align: center;">   <small>W20-7 A 48" X 48"</small> </div> </div> <p style="text-align: center;">PLACED 500' IN ADVANCE OF FLAGGER. PLACED 250' IN ADVANCE OF FLAGGER.</p>
	③		<p>PLACE INITIALLY AT THE CONSTRUCTION LIMITS AND SPACED 1 MILE APART THEREAFTER. IF NO -Y- LINES EXIST, PLACE 2ND SET 1/2 MILE FROM THE CONSTRUCTION LIMITS AND THEN SPACE 1 MILE THEREAFTER.</p>	
	④		<p>THESE ARE FOR -Y- LINES THAT ARE "THROUGH" ROADWAYS. DEAD END AND SUBDIVISION ROADS ARE NOT "THROUGH" ROADWAYS. INSTALL 500' +/- FROM EACH -Y- LINE APPROACH AS SHOWN ABOVE. FOR MULTIPLE -Y- LINES THAT ARE SEPARATED BY 0.25 MILES OR LESS, TREAT AS A SINGLE UNIT AND INSTALL WITHIN 500' OF EACH APPROACH. A MAXIMUM OF 2 SIGN SETS PER MILE. DO NOT INSTALL WHEN -Y- LINES ARE WITHIN 0.5 MILES FROM "END ROAD WORK" SIGN.</p>	
	⑤		<p>PLACE 500' FOLLOWING THE END OF CONSTRUCTION LIMITS.</p>	

21-SEP-2017 09:23  
 3:ADISTRIC1ST0101CAD293538  
 fccddy AT D:\CAD293538



**RESURFACING  
 ADVANCE WARNING SIGNS  
 FOR  
 RURAL AND SUBURBAN  
 2 LANE ROADWAYS**

PROJECT NO.	SHEET NO.	TOTAL NO.
2018CPT.01.10.20272.1, ETC.		

## SUMMARY OF QUANTITIES

PROJECT NO	COUNTY	MAP NO	ROUTE	DESCRIPTION	TYP NO	LANES	LANE TYPE	FINAL SURFACE TESTING REQUIRED	WARM MIX ASPHALT REQUIRED	LENGTH	WIDTH	MOBILIZATION	BORROW	INCIDENTAL STONE BASE	SHOULDER RECONSTRUCTION	1½" MILLING	SURFACE COURSE, SF9.5A	SURFACE COURSE, S4.75A	ASPHALT BINDER FOR PLANT MIX	FRAME WITH GRATE, STD 840.**** ^ EA	RETROFIT EXISTING CURB RAMP	CONCRETE CURB RAMP	ADJ. OF MANHOLES			
																								MI	FT	LS
2018CPT.01.10.20271.1	Currituck	1	SR 1437 NORTH BEACH ACCESS	FROM DEAD END TO NC 12	2	2	2WU	NO	NO	1.07	32	1	100	10	2.00		1,885		126		7					
<b>TOTAL FOR PROJ NO. 2018CPT.01.10.20271.1</b>																										
2018CPT.01.10.20272.1	Currituck	2	SR 1422 SANDHILL LANE	FROM CULDESAC TO NC 12	1	2	2WU	NO	NO	0.18	20	1						92	6							
2018CPT.01.10.20272.1	Currituck	3	SR 1423 SANDBUCKET ARCH RD	FROM CULDESAC TO CULDESAC	1	2	2WU	NO	NO	0.34	20	*						173	12							
2018CPT.01.10.20272.1	Currituck	4	SR 1424 SEA SHELL LANE	FROM CULDESAC TO NC 12	1	2	2WU	NO	NO	0.2	20	*						102	7							
2018CPT.01.10.20272.1	Currituck	5	SR 1425 CONCH CRESENT	FROM CULDESAC TO CULDESAC	1	2	2WU	NO	NO	0.36	20	*						184	12							
2018CPT.01.10.20272.1	Currituck	6	SR 1426 OCEAN WAY RD	FROM CULDESAC TO NC 12	1	2	2WU	NO	NO	0.19	20	*						97	7							
2018CPT.01.10.20272.1	Currituck	7	SR 1427 BREAKERS ARCH RD	FROM CULDESAC TO CULDESAC	1	2	2WU	NO	NO	0.36	20	*						184	12							
2018CPT.01.10.20272.1	Currituck	8	SR 1406 SCHOOL HOUSE LANE	FROM SR 1185 TO NC 12	1	2	2WU	NO	NO	0.13	20	*		20				66	5							
2018CPT.01.10.20272.1	Currituck	9	SR 1185 COROLLA VILLAGE RD	FROM CUL DE SAC TO NC 12	1	2	2WU	NO	NO	0.52	20	*		100				265	18							
2018CPT.01.10.20272.1	Currituck	10	SR 1400 COROLLA DR	FROM SR 1402 TO SR 1409	1	2	2WU	NO	NO	2.93	20	*		10				1,494	102		13					
2018CPT.01.10.20272.1	Currituck	11	SR 1402 ALBACORE ST	FROM SR 1403 TO NC 12	1	2	2WU	NO	NO	0.37	21	*		5				198	13							
2018CPT.01.10.20272.1	Currituck	12	SR 1409 SHAD ST	FROM SR 1403 TO NC 12	1	2	2WU	NO	NO	0.27	22	*		2				151	10		1					
2018CPT.01.10.20272.1	Currituck	13	SR 1420 WHALEHEAD DR	FROM SR 1409 TO SR 1402	1	2	2WU	NO	NO	2.93	20	*		15				1,494	102		10					
2018CPT.01.10.20272.1	Currituck	14	SR 1457 BONITA ST	FROM SR 1403 TO NC 12	1	2	2WU	NO	NO	0.22	20	*		1				112	8							
2018CPT.01.10.20272.1	Currituck	15	SR 1458 DOLPHIN STREET	FROM SR 1403 TO NC 12	1	2	2WU	NO	NO	0.22	20	*		2				112	8							
<b>TOTAL FOR PROJ NO. 2018CPT.01.10.20272.1</b>																										
2018CPT.01.10.20281.1	Dare	16	SR 1113 MASHOES RD	FROM STATION 52+80 TO DEAD END	2	2	2WU	NO	NO	4.73	18	1	1,000	40	9.40				255							
2018CPT.01.10.20281.1	Dare	17	SR 1197 AGONA STREET	FROM US 64 TO NC 400	3	2	2WU	NO	NO	0.28	20	*		9		3,285	250	17	4.00			4				
2018CPT.01.10.20281.1	Dare	18	SR 1300 GARETH CIRCLE	FROM US 64 TO CUL DE SAC	2	2	2WU	NO	NO	0.29	22	*	80	10	0.50		328	22								
2018CPT.01.10.20281.1	Dare	19	SR 1432 BLUE BEARD RD	FROM NC 12 TO SR 1431	2	2	2WU	NO	NO	0.12	20	*	25	1	0.24		129	9								
2018CPT.01.10.20281.1	Dare	20	SR 1433 JOLLY ROGER RD	FROM NC 12 TO SR 1431	2	2	2WU	NO	NO	0.13	20	*	25	1	0.26		139	9								
2018CPT.01.10.20281.1	Dare	21	SR 1437 SKIP JACK CT	FROM SR 1431 TO CULDESAC	2	2	2WU	NO	NO	0.07	20	*	15	1	0.14		75	5								
2018CPT.01.10.20281.1	Dare	22	SR 1438 MERRIMAC CT	FROM SR 1431 TO SR 1435	2	2	2WU	NO	NO	0.14	20	*	50	1	0.28		150	10								
2018CPT.01.10.20281.1	Dare	23	SR 1440 CUTLASS LN	FROM SR 1431 TO SR 1435	2	2	2WU	NO	NO	0.16	20	*	50	1	0.32		171	11								
2018CPT.01.10.20281.1	Dare	24	SR 1441 QUAY LN	FROM SR 1431 TO CULDESAC	2	2	2WU	NO	NO	0.11	20	*	25	1	0.22		118	8								
2018CPT.01.10.20281.1	Dare	25	SR 1443 BOSUN ST	FROM SR 1435 TO NC 12	2	2	2WU	NO	NO	0.06	20	*	25	1	0.12		64	4								
2018CPT.01.10.20281.1	Dare	26	SR 1446 W. DORY RD	FROM NC 12 TO DEAD END	2	2	2WU	NO	NO	0.11	20	*	25	1	0.22		117	8								
2018CPT.01.10.20281.1	Dare	27	SR 1119 GEORGE DANIELS RD	FROM SR 1118 TO SR 1354	2	2	2WU	NO	NO	0.32	20	*	75	20	0.64		343	23								
2018CPT.01.10.20281.1	Dare	28	SR 1354 OLD CEMETARY ROAD	FROM SR 1119 TO SR 1337	2	2	2WU	NO	NO	0.1	20	*	25	2	0.20		107	7								
2018CPT.01.10.20281.1	Dare	29	SR 1337 WESCOTT PARK	FROM SR 1119 TO SR 1354	2	2	2WU	NO	NO	0.2	20	*	50	10	0.40		214	14								
2018CPT.01.10.20281.1	Dare	30	SR 1121 WINGINA AVE	FROM SR 1995 TO SR 1150	3	2	2WU	NO	NO	0.1	20	*				1,173	107				1					
2018CPT.01.10.20281.1	Dare	31	SR 1150 BUDLEIGH ST	FROM US 64 TO NC 400	3	2	2WU	NO	NO	0.36	20	*		2		4,224	386	26				9				
2018CPT.01.10.20281.1	Dare	53	SR 1297 POTESKEET DR	FROM NC 12 TO DEAD END	2	2	2WU	NO	NO	0.53	20	*	200	40	1.00		1,118	75				12				
<b>TOTAL FOR PROJ NO. 2018CPT.01.10.20281.1</b>																										
2018CPT.01.10.20282.1	Dare	32	SR 1113 MASHOES RD	FROM US 64 TO STATION 52+80	1	2	2WU	NO	NO	1	18	1		20				459	31							
2018CPT.01.10.20282.1	Dare	33	SR 1524 TERN ST	FROM NC 12 TO SR 1421	1	2	2WU	NO	NO	0.05	20	*		5				25	2							
2018CPT.01.10.20282.1	Dare	34	SR 1525 YUCCA ST	FROM NC 12 TO SR 1421	1	2	2WU	NO	NO	0.05	20	*		5				25	2							
2018CPT.01.10.20282.1	Dare	35	SR 1422 PAMPAS ST	FROM NC 12 TO SR 1421	1	2	2WU	NO	NO	0.06	20	*		5				31	2							
2018CPT.01.10.20282.1	Dare	36	SR 1423 MYRTLE ST	FROM NC 12 TO SR 1421	1	2	2WU	NO	NO	0.06	20	*		5				31	2							
2018CPT.01.10.20282.1	Dare	37	SR 1424 SEASIDE ST	FROM NC 12 TO SR 1421	1	2	2WU	NO	NO	0.06	20	*		5				31	2							
2018CPT.01.10.20282.1	Dare	38	SR 1421 OCEAN VIEW DR	FROM NC 12 TO CUL DE SAC	1	2	2WU	NO	NO	1.09	20	*		5				556	38							
2018CPT.01.10.20282.1	Dare	39	SR 1419 GREENWOOD PL	FROM NC 12 TO CUL DE SAC	1	2	2WU	NO	NO	0.32	20	*		5				163	11							
2018CPT.01.10.20282.1	Dare	40	SR 1420 KINNAKEET DR	NC 12 TO SR 1419	1	2	2WU	NO	NO	0.05	20	*		5				25	2							
2018CPT.01.10.20282.1	Dare	41	SR 1494 MOORE WAY	FROM NC 12 TO CUL DE SAC	1	2	2WU	NO	NO	0.09	20	*		5				46	3							
2018CPT.01.10.20282.1	Dare	42	SR1485 KINNAKEET DR	FROM NC 12 TO SR 1486	1	2	2WU	NO	NO	0.04	20	*		5				20	1							
2018CPT.01.10.20282.1	Dare	43	SR 1486 PHEASANT CIRCLE	FROM SR 1485 TO CUL DE SAC	1	2	2WU	NO	NO	0.16	20	*		5				82	6							
2018CPT.01.10.20282.1	Dare	44	SR 1488 CEDAR CIRCLE	FROM SR 1485 TO CUL DE SAC	1	2	2WU	NO	NO	0.16	20	*		5				82	6							
2018CPT.01.10.20282.1	Dare	45	SR 1501 KINNAKEET DR NORTH	FROM NC 12 TO CUL DE SAC	1	2	2WU	NO	NO	0.09	20	*		5				46	3							
2018CPT.01.10.20282.1	Dare	46	SR 1500 NOVA DR	FROM NC 12 TO DEAD END	1	2	2WU	NO	NO	0.09	20	*		5				46	3							
2018CPT.01.10.20282.1	Dare	47	SR 1280 COLONY LANE	FROM NC 12 TO JOLLIE RD	1	2	2WU	NO	NO	0.11	20	*		5				56	4							
2018CPT.01.10.20282.1	Dare	48	SR1282 HATTERAS LANE	FROM NC 12 TO JOLLIE LANE	1	2	2WU	NO	NO	0.1	20	*		5				51	3							
2018CPT.01.10.20282.1	Dare	49	SR 1268 WAHOO CIRCLE	FROM NC 12 TO DEAD END	1	2	2WU	NO	NO	0.09	20	*		5				46	3							
2018CPT.01.10.20282.1	Dare	50	SR 1264 SANDFIDDLER LANE	FROM NC 12 TO CUL DE SAC	1	2	2WU	NO	NO	0.08	20	*		5				41	3							
2018CPT.01.10.20282.1	Dare	51	SR 1261 ANGELFISH RD	FROM NC 12 TO DEAD END	1	2	2WU	NO	NO	0.1	20	*		5				51	3							
2018CPT.01.10.20282.1	Dare	52	SR 1263 SAILFISH LANE	FROM NC 12 TO CUL DE SAC	1	2	2WU	NO	NO	0.1	20	*		5				51	3							
<b>TOTAL FOR PROJ NO. 2018CPT.01.10.20282.1</b>																										
<b>GRAND TOTAL</b>										<b>22.05</b>		<b>1</b>	<b>1770</b>	<b>426</b>	<b>15.94</b>	<b>8682</b>	<b>9500</b>	<b>6688</b>	<b>1091</b>	<b>4</b>	<b>31</b>	<b>13</b>	<b>13</b>			

PROJECT NO.	SHEET NO.	TOTAL NO.
2018CPT.01.10.20271.1		

## SUMMARY OF QUANTITIES

PROJECT NO	COUNTY	MAP NO	ROUTE	DESCRIPTION	TYP NO	LANES	LANE TYPE	FINAL SURFACE TESTING REQUIRED	WARM MIX ASPHALT REQUIRED	LENGTH	WIDTH	ADJ. OF METER OR VALVE BOX	TEMPORARY TRAFFIC CONTROL	WORK ZONE SIGNS (STATIONARY)	SEED & MULCHING	GENERIC PAVEMENT MARKING ITEM (PROFILED PVT MARKING LINE)	4" X 90 M WHITE THERMO	4" X 120 M YELLOW THERMO	8" X 120 M WHITE THERMO	24" X 120 M WHITE THERMO	4" WHITE PAINT	4" YELLOW PAINT	8" WHITE PAINT	24" WHITE PAINT																				
																									MI	FT	EA	LS	SF	AC	LF	LF	LF	LF	LF	LF	LF							
2018CPT.01.10.20271.1	Currituck	1	SR 1437 NORTH BEACH ACCESS	FROM DEAD END TO NC 12	2	2	2WU	NO	NO	1.07	32		1	44	1.00	11,300		11,300		250	11,300	11,300		250																				
<b>TOTAL FOR PROJ NO. 2018CPT.01.10.20271.1</b>																														<b>1.07</b>			<b>1</b>	<b>44</b>	<b>1</b>	<b>11,300</b>		<b>11,300</b>		<b>250</b>	<b>11,300</b>		<b>250</b>	
																						<b>22,600</b>		<b>250</b>																				
2018CPT.01.10.20272.1	Currituck	2	SR 1422 SANDHILL LANE	FROM CULDESAC TO NC 12	1	2	2WU	NO	NO	0.18	20	3	1	20																														
2018CPT.01.10.20272.1	Currituck	3	SR 1423 SANDBUCKET ARCH RD	FROM CULDESAC TO CULDESAC	1	2	2WU	NO	NO	0.34	20		*																															
2018CPT.01.10.20272.1	Currituck	4	SR 1424 SEA SHELL LANE	FROM CULDESAC TO NC 12	1	2	2WU	NO	NO	0.2	20		*	20																														
2018CPT.01.10.20272.1	Currituck	5	SR 1425 CONCH CRESENT	FROM CULDESAC TO CULDESAC	1	2	2WU	NO	NO	0.36	20		*																															
2018CPT.01.10.20272.1	Currituck	6	SR 1426 OCEAN WAY RD	FROM CULDESAC TO NC 12	1	2	2WU	NO	NO	0.19	20	3	*	20																														
2018CPT.01.10.20272.1	Currituck	7	SR 1427 BREAKERS ARCH RD	FROM CULDESAC TO CULDESAC	1	2	2WU	NO	NO	0.36	20		*																															
2018CPT.01.10.20272.1	Currituck	8	SR 1406 SCHOOL HOUSE LANE	FROM SR 1185 TO NC 12	1	2	2WU	NO	NO	0.13	20		*	20																														
2018CPT.01.10.20272.1	Currituck	9	SR 1185 COROLLA VILLAGE RD	FROM CUL DE SAC TO NC 12	1	2	2WU	NO	NO	0.52	20		*	44																														
2018CPT.01.10.20272.1	Currituck	10	SR 1400 COROLLA DR	FROM SR 1402 TO SR 1409	1	2	2WU	NO	NO	2.93	20		*	44			31,000	31,000		400	31,000	31,000		400																				
2018CPT.01.10.20272.1	Currituck	11	SR 1402 ALBACORE ST	FROM SR 1403 TO NC 12	1	2	2WU	NO	NO	0.37	21		*	44																														
2018CPT.01.10.20272.1	Currituck	12	SR 1409 SHAD ST	FROM SR 1403 TO NC 12	1	2	2WU	NO	NO	0.27	22		*	44				100	50			100	50																					
2018CPT.01.10.20272.1	Currituck	13	SR 1420 WHALEHEAD DR	FROM SR 1409 TO SR 1402	1	2	2WU	NO	NO	2.93	20		*	44			31,000	31,000		50	31,000	31,000		50																				
2018CPT.01.10.20272.1	Currituck	14	SR 1457 BONITA ST	FROM SR 1403 TO NC 12	1	2	2WU	NO	NO	0.22	20		*	44																														
2018CPT.01.10.20272.1	Currituck	15	SR 1458 DOLPHIN STREET	FROM SR 1403 TO NC 12	1	2	2WU	NO	NO	0.22	20		*	44																														
<b>TOTAL FOR PROJ NO. 2018CPT.01.10.20272.1</b>																														<b>9.22</b>		<b>6</b>	<b>1</b>	<b>388</b>			<b>62000</b>	<b>62000</b>	<b>100</b>	<b>500</b>	<b>62000</b>	<b>62000</b>	<b>100</b>	<b>500</b>
																						<b>124,000</b>																						
2018CPT.01.10.20281.1	Dare	16	SR 1113 MASHOES RD	FROM STATION 52+80 TO DEAD END	2	2	2WU	NO	NO	4.73	18		1	44	2.00		101,790	62,436			151,750	62,000																						
2018CPT.01.10.20281.1	Dare	17	SR 1197 AGONA STREET	FROM US 64 TO NC 400	3	2	2WU	NO	NO	0.28	20	5	*	44																														
2018CPT.01.10.20281.1	Dare	18	SR 1300 GARETH CIRCLE	FROM US 64 TO CUL DE SAC	2	2	2WU	NO	NO	0.29	22		*	44	1.00			3,000				3,000																						
2018CPT.01.10.20281.1	Dare	19	SR 1432 BLUE BEARD RD	FROM NC 12 TO SR 1431	2	2	2WU	NO	NO	0.12	20		*	44	0.01																													
2018CPT.01.10.20281.1	Dare	20	SR 1433 JOLLY ROGER RD	FROM NC 12 TO SR 1431	2	2	2WU	NO	NO	0.13	20		*	44	0.01																													
2018CPT.01.10.20281.1	Dare	21	SR 1437 SKIP JACK CT	FROM SR 1431 TO CULDESAC	2	2	2WU	NO	NO	0.07	20		*	44	0.01																													
2018CPT.01.10.20281.1	Dare	22	SR 1438 MERRIMAC CT	FROM SR 1431 TO SR 1435	2	2	2WU	NO	NO	0.14	20		*	44	0.02																													
2018CPT.01.10.20281.1	Dare	23	SR 1440 CUTLASS LN	FROM SR 1431 TO SR 1435	2	2	2WU	NO	NO	0.16	20		*	44	0.02																													
2018CPT.01.10.20281.1	Dare	24	SR 1441 QUAY LN	FROM SR 1431 TO CULDESAC	2	2	2WU	NO	NO	0.11	20		*	44	0.01																													
2018CPT.01.10.20281.1	Dare	25	SR 1443 BOSUN ST	FROM SR 1435 TO NC 12	2	2	2WU	NO	NO	0.06	20		*	44	0.01																													
2018CPT.01.10.20281.1	Dare	26	SR 1446 W. DORY RD	FROM NC 12 TO DEAD END	2	2	2WU	NO	NO	0.11	20		*	44	0.01																													
2018CPT.01.10.20281.1	Dare	27	SR 1119 GEORGE DANIELS RD	FROM SR 1118 TO SR 1354	2	2	2WU	NO	NO	0.32	20		*	44	0.30																													
2018CPT.01.10.20281.1	Dare	28	SR 1354 OLD CEMETARY ROAD	FROM SR 1119 TO SR 1337	2	2	2WU	NO	NO	0.1	20		*	44	0.01																													
2018CPT.01.10.20281.1	Dare	29	SR 1337 WESCOTT PARK	FROM SR 1119 TO SR 1354	2	2	2WU	NO	NO	0.2	20		*	44	0.02																													
2018CPT.01.10.20281.1	Dare	30	SR 1121 WINGINA AVE	FROM SR 1995 TO SR 1150	3	2	2WU	NO	NO	0.1	20		*	44																														
2018CPT.01.10.20281.1	Dare	31	SR 1150 BUDLEIGH ST	FROM US 64 TO NC 400	3	2	2WU	NO	NO	0.36	20	10	*	44				2,376				2,300																						
2018CPT.01.10.20281.1	Dare	53	SR 1297 POTESKEET DR	FROM NC 12 TO DEAD END	2	2	2WU	NO	NO	0.53	20		*	44	1.00																													
<b>TOTAL FOR PROJ NO. 2018CPT.01.10.20281.1</b>																														<b>7.81</b>		<b>15</b>	<b>1</b>	<b>748</b>	<b>4.43</b>		<b>101,790</b>	<b>67,812</b>			<b>151,750</b>	<b>67,300</b>		
																						<b>219,050</b>																						
2018CPT.01.10.20282.1	Dare	32	SR 1113 MASHOES RD	FROM US 64 TO STATION 52+80	1	2	2WU	NO	NO	1	18		1	44			10,760	6,600			10,000	6,600																						
2018CPT.01.10.20282.1	Dare	33	SR 1524 TERN ST	FROM NC 12 TO SR 1421	1	2	2WU	NO	NO	0.05	20		*																															
2018CPT.01.10.20282.1	Dare	34	SR 1525 YUCCA ST	FROM NC 12 TO SR 1421	1	2	2WU	NO	NO	0.05	20		*																															
2018CPT.01.10.20282.1	Dare	35	SR 1423 PAMPAS ST	FROM NC 12 TO SR 1421	1	2	2WU	NO	NO	0.06	20		*																															
2018CPT.01.10.20282.1	Dare	36	SR 1423 MYRTLE ST	FROM NC 12 TO SR 1421	1	2	2WU	NO	NO	0.06	20		*																															
2018CPT.01.10.20282.1	Dare	37	SR 1424 SEASIDE ST	FROM NC 12 TO SR 1421	1	2	2WU	NO	NO	0.06	20		*																															
2018CPT.01.10.20282.1	Dare	38	SR 1421 OCEAN VIEW DR	FROM NC 12 TO CUL DE SAC	1	2	2WU	NO	NO	1.09	20		*																															
2018CPT.01.10.20282.1	Dare	39	SR 1419 GREENWOOD PL	FROM NC 12 TO CUL DE SAC	1	2	2WU	NO	NO	0.32	20		*																															
2018CPT.01.10.20282.1	Dare	40	SR 1420 KINNAKEET DR	NC 12 TO SR 1419	1	2	2WU	NO	NO	0.05	20		*																															
2018CPT.01.10.20282.1	Dare	41	SR 1494 MOORE WAY	FROM NC 12 TO CUL DE SAC	1	2	2WU	NO	NO	0.09	20		*																															
2018CPT.01.10.20282.1	Dare	42	SR1485 KINNAKEET DR	FROM NC 12 TO SR 1486	1	2	2WU	NO	NO	0.04	20		*																															
2018CPT.01.10.20282.1	Dare	43	SR 1486 PHEASANT CIRCLE	FROM SR 1485 TO CUL DE SAC	1	2	2WU	NO	NO	0.16	20		*																															
2018CPT.01.10.20282.1	Dare	44	SR 1488 CEDAR CIRCLE	FROM SR 1485 TO CUL DE SAC	1	2	2WU	NO	NO	0.16	20		*																															
2018CPT.01.10.20282.1	Dare	45	SR 1501 KINNAKEET DR NORTH	FROM NC 12 TO CUL DE SAC	1	2	2WU	NO	NO	0.09	20		*																															
2018CPT.01.10.20282.1	Dare	46	SR 1500 NOVA DR	FROM NC 12 TO DEAD END	1	2	2WU	NO	NO	0.09	20		*																															
2018CPT.01.10.20282.1	Dare	47	SR 1280 COLONY LANE	FROM NC 12 TO JOLLIE RD	1	2	2WU	NO	NO	0.11	20		*																															
2018CPT.01.10.20282.1	Dare	48	SR1282 HATTERAS LANE	FROM NC 12 TO JOLLIE LANE	1	2	2WU	NO	NO	0.1	20		*																															
2018CPT.01.10.20282.1	Dare	49	SR 1268 WAHOO CIRCLE	FROM NC 12 TO DEAD END	1	2	2WU	NO	NO	0.09	20		*																															
2018CPT.01.10.20282.1	Dare	50	SR 1264 SANDFIDDLER LANE	FROM NC 12 TO CUL DE SAC	1	2	2WU	NO	NO	0.08	20		*																															
2018CPT.01.10.20282.1	Dare	51	SR 1261 ANGELFISH RD	FROM																																								



# VIBRALINE DETAIL

